

# San Ramon Valley Unified School District

Facility Development Committee (FDC)

**MEETING #04: REPORT**

OCTOBER 5, 2023 5:30 – 7:30pm



# SUMMARY

## Zoom Chat Log

- **Maddy Henry:** All Access Restrooms are a great solution- thank you!
- **Ken Mintz:** re: Shared Use agreements - important to share conceptual plans with groups that use those facilities in advance so down the line we don't have big issues based on the plans
- **Torri Rhyne:** If the San Ramon Golf course is developed do the plans take into account room for potential growth at Country Club and Walt Disney?
- **Jennifer Jones:** As a teacher who has been in education for 27 years - seeing the care and thought to the actual environment students will be learning, growing, and thriving in is amazing! As a TK teacher at Creekside, I'm so excited to see the new TK spaces! 😊
- **Torri Rhyne:** Well said, Jennifer!
- **Candace Hendra:** Senior Advisory Commission: What is the plan to speak to/inform the Town of Danville about those campuses with shared space?
- **Erin Hirst:** Facilities will connect with Town of Danville and City of San Ramon
- **Candace Hendra:** Sounds great—I am on a Town of Danville commission-happy to help in any way
- **Cara Mattia-Varon, teacher at Monte Vista:** - Have you looked into the junior lot (has solar panels), can the dirt lot next to it be used as overflow parking?
- **Jon Isom:** Any plans to use the underutilized JV field to install artificial turf? The drainage is awful.
- **Andrea Pippin:** looking into making sure we are equitable and looking at the return on investment, we will get costs at least plugged in below the line so the District knows what it will cost.

# SUMMARY

## Zoom Chat Log

- **Ken Mintz:** any talk about staff housing? any ideas of potentially closing any schools? how does that fit in?
- **Stella Kemp:** We are looking at our demographic projections. Updating it this year. Watching Bishop Ranch closely. If enrollment projections were to be so low that it makes sense to close a school we would plan for that. It takes a huge lead time to do that. Its not ideal for teachers in a school with enrollment too low, then teachers have to teach combo classes (i.e. grades 3,4,5 in one class)
- **Ken Mintz:** 20 years ago when planning Dougherty Valley we had a much lower number. The enrollment doubled. We might have the opposite on some campuses. Could be a time bomb no one wants to talk about but its important.
- **Jennifer Jones:** I may have missed it, but are there any plans to update the district office facilities in the long range plan?
- **Andrea Pippin:** Yes. We focused on the campuses for now but we will also include that in the long range plan.
- **John Isom:** Careful in how we replace portables and not overbuild. Strategically choose which portables should be replaced.

### **Mural Link:**

<https://app.mural.co/t/lpadesignstudios2268/m/lpadesignstudios2268/1694731917448/19baee892e157ef4c6aa74c4e73a711617d27e7?sender=u368cc703dd4baac30f0d9148>

# **THANK YOU**

for your participation

Abdul Mixon

Anya

Candace Hendra

Cara Mattia-Varon

Diane Schumacher

Erin Hirst

Evan Powell

Hong Nguyen

Jennifer Hunau

Jennifer Jones

Jon Isom

Kelly Hilton

Ken Mintz

Kevin Ahern

Krystin Alcaraz

Laura Finco

Maddy

Melanie Jensen

Mishel Rahman

Nadine Rosenzweig

Nhi Pham

Shelley Clark, Trustee

Stella Kemp

Sumita Bhandari

Torri Rhyne

Vivian Nguyen

# **APPENDIX**



# San Ramon Valley Unified School District

Facility Development Committee (FDC)

**MEETING #04: TOWN HALL DEBRIEF**

**OCTOBER 5, 2023 5:30 – 7:30pm**



# San Ramon Valley Unified School District Strategic Directions



SRVUSD... Dedicated to academic excellence where all students thrive and succeed in innovative and inclusive learning environments.

Success means our students:

- Achieve academically
- Experience social and emotional well-being
- Develop curiosity, confidence, and independence as learners
- Appreciate the importance of teams and collaboration
- Demonstrate empathy and compassion
- Determine their purpose and understand the importance of service
- Set and achieve goals
- Love learning

Built on a foundation of academic excellence, we are broadening our definition of success.  
Success means our teams create and nurture:

**DEEP LEARNING AND INNOVATION**  
We will create learning environments that empower students to own their learning so they find purpose, meaning, and joy in their education and excel in post-high school endeavors.

**EQUITY**  
We will ensure all students are empowered to reach their full potential by valuing student voice, addressing systemic inequities, and closing opportunity gaps.

**SOCIAL EMOTIONAL WELL-BEING**  
We are committed to creating and nurturing inclusive learning environments where all students, staff, and families feel deeply connected to their school community.

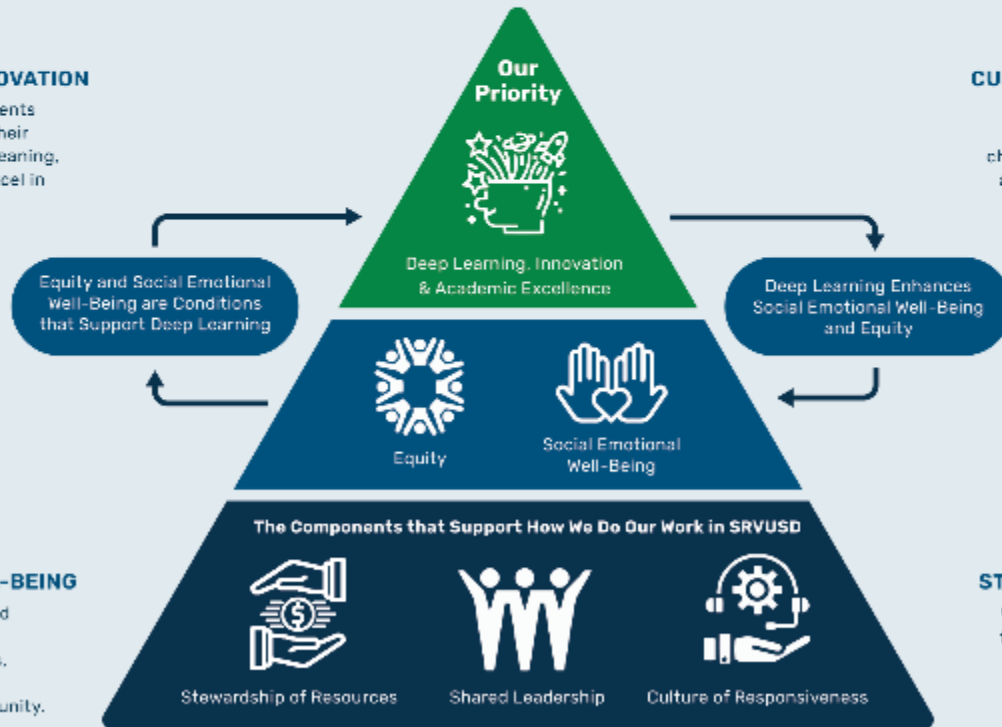

**CULTURE OF RESPONSIVENESS**  
We will effectively serve all partners by listening, responding promptly, changing practices when appropriate, and communicating the rationale for decisions so students remain the focus of our efforts.

**SHARED LEADERSHIP**  
We will create the conditions for shared leadership by building a culture of trust, collegiality, and shared responsibility with students, staff, and families.

**STEWARDSHIP OF RESOURCES**  
We will maximize resources including time, talent, and finances to advance our student success goals.

## Translating the Strategic Directions into the Built Environment

*At the kickoff Ed Specs Visioning Workshop, participants were asked to think how the built environment could better support the Strategic Directions.*

# AGENDA: FINDINGS & WORK-IN-PROGRESS

## 5:30 - 5:45

Schedule

Student and Community Survey Results Update

Districtwide Patterns Observed

- Needs from Campus Visioning Workshops
- Input from Town Halls and Follow-Up Meetings
- Common Questions

## 5:45 - 6:00

Design Guidelines Revisions made from Town Halls

## 6:00 - 7:30

Review Site Diagrams

Town Halls & School Site Committee Follow-Ups

20 minutes each Town Hall grouping:

- Review & Group Discussion





# SCHEDULE & AGENDA: FACILITIES DEVELOPMENT COMMITTEE

## Meeting #1

February 6  
Mon 5:45-7:45  
Virtual

### “If You Could Dream”

FMP Process & Schedule Overview  
Draft Community Survey Review for Input  
Draft Guiding Principles  
Community Asset Mapping

## Meeting #2

March 20  
Mon 5:45-7:45  
Virtual

### Findings

Facility Condition Assessment Findings  
Ed Specs Focus Group Findings  
Campus Visioning Workshop Emerging Patterns  
Engagement Activity Challenges & Strategies

## Meeting #3

May 23  
Tues 5:30-7:30  
PDC – in person

### Findings - Update

Site Ratings Draft  
Kitchen Nutrition Plan  
Ed Spec Focus Group Gallery Walk  
Campus Vision Report & Activity

## Meeting #4

Oct 5  
Thurs 5:30-7:30  
Virtual

### Community Forums Debrief

Final Site Plan Diagrams  
Final Ed Specs  
Community Engagement Survey Results Update

## Meeting #5

Nov 30  
Thurs 5:30-7:30  
PDC – in person

### Project Prioritization

Total Program Cost & Potential Funding Sources  
Stakeholder Groups Priorities  
SRVUSD Planning Team Prioritization Activity



# LONG RANGE FACILITIES PLAN **SCHEDULE UPDATE**

- SRVUSD Facility Development Committee Meetings: Monthly since February 6<sup>th</sup>
- Site Committee Visioning Workshops #1: February 16<sup>th</sup> – March 10<sup>th</sup>
- Final Draft Facilities Condition Assessments complete
- Community Online Surveys: deployed August 22, 2023
- (4) Town Halls: 9/7: Cal HS, 9/13: Dougherty HS, 9/14: Monte Vista, 9/20: SRVHS

## NEXT STEPS

- **Town Hall Follow-Ups:** 30 min. virtual call with school sites following their Town Hall
- **Finalize site plan diagrams, cost estimating:** October / November
- **Goal: Project Prioritization, finalize website, Board approval by February 2024**

Students and Community

**Survey Results Update as of 10/5/23**

# UNDERSTANDING THE NUMBERS: STUDENT SURVEY

updated: 10.5.23 (no change in resulting trends since 9.5.23)



## 9,934 Total Responses

4<sup>th</sup> and 5<sup>th</sup> Graders: 30%

6<sup>th</sup> through 8<sup>th</sup> Graders: 60%

9<sup>th</sup> through 12<sup>th</sup> Graders: 10%

# UNDERSTANDING THE NUMBERS: STUDENT SURVEY

updated: 10.5.23 (no change in resulting trends since 9.5.23)



## Clear Majority (95% +) of participants believe...

- Beyond core academics, what is important to their learning experience are:
  - **STEAM** (Science, Technology, Engineering, Art, Math)
  - **learning at my own pace**
  - **hands-on or project-based learning**
- All skills are important to develop:
  - **problem-solving**
  - **organization and time management**
  - **adapting to new situations**
  - **self-motivation**
  - **critical, creative, and curious thinking**
  - **producing high quality work**

# UNDERSTANDING THE NUMBERS: STUDENT SURVEY

updated: 10.5.23 (no change in resulting trends since 9.5.23)



## About 80% of participants feel...

- Safe and **ready to learn** at my school.
- **Physically safe** on my school campus.
- **Welcome** at my school.

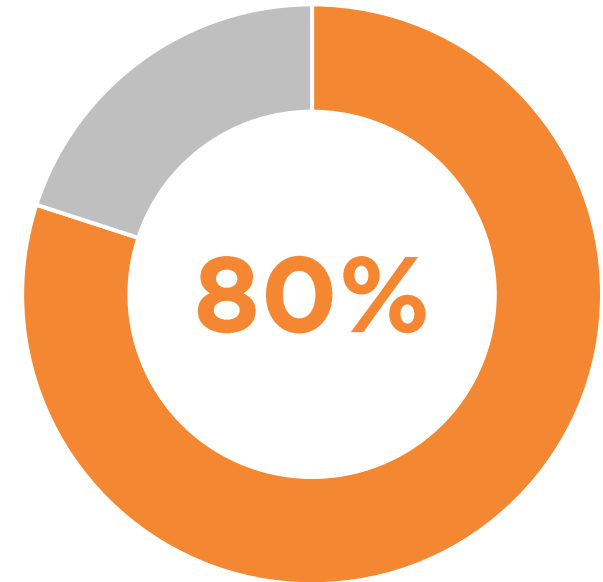

# UNDERSTANDING THE NUMBERS: STUDENT SURVEY

updated: 10.5.23 *(no change in resulting trends since 9.5.23)*



## About 66% to 72% of participants believe...

- In general, the facilities at my school are **in good shape**.
- Their school is doing a good job **protecting the environment**.
- I appreciate getting **recognized** with awards at schoolwide ceremonies.
- I enjoy **studying and reading** in the Library.
- My school's Library has all the **resources** I need.

# UNDERSTANDING THE NUMBERS: STUDENT SURVEY

updated: 10.5.23 (no change in resulting trends since 9.5.23)



## SRVUSD should consider additional Industry Sectors for Career Technical Education...

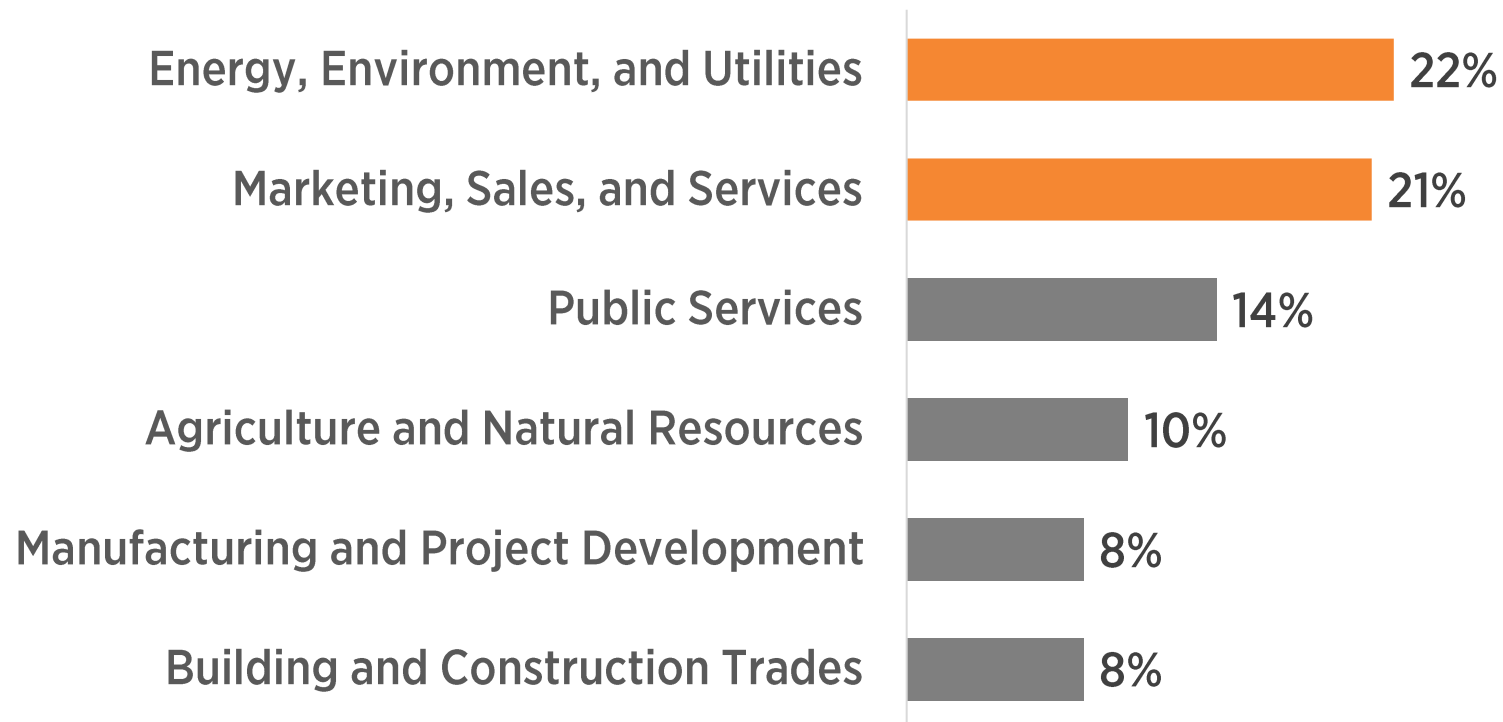



# UNDERSTANDING THE NUMBERS: COMMUNITY SURVEY

updated: 10.5.23



## 2,454 Total Responses

Community Members:	699
Parents:	1,838
Staff:	566
Site Administrators:	24
District Administrator:	16
Other:	170 ( <i>mostly students</i> )

# UNDERSTANDING THE NUMBERS: COMMUNITY SURVEY

updated: 10.5.23



## Clear Majority (70%) of participants believe...

- **School facilities...**
  - are in good shape.
  - **should be a role model for environmental stewardship** for the community.
  - should be **used as a tool for teaching** real-world lessons about sustainability.
  - **feel welcoming for students and visitors.**
  - **support the academic and social-emotional needs of students.**

# UNDERSTANDING THE NUMBERS: COMMUNITY SURVEY

updated: 9.5.23



## About 65% of participants believe...

- The school is a **safe and secure campus** for students and staff.
- The school facilities need **updating and modernizing** to support future-ready learning.

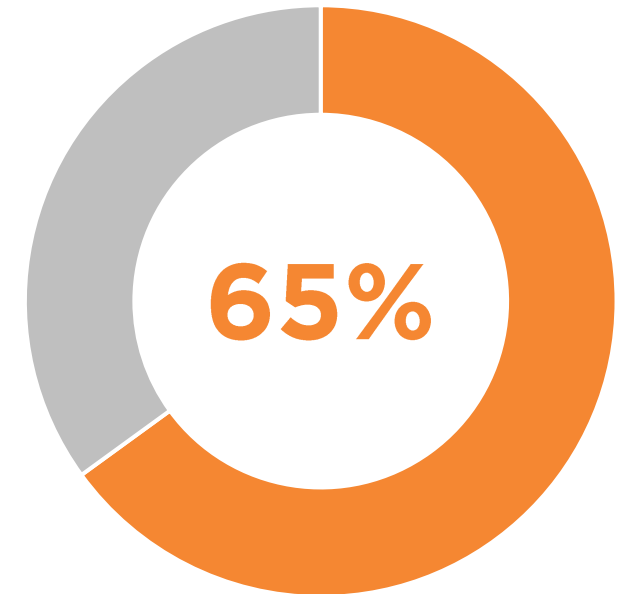

# UNDERSTANDING THE NUMBERS: COMMUNITY SURVEY

updated: 10.5.23



## Beyond core academics, I value these offerings the most:

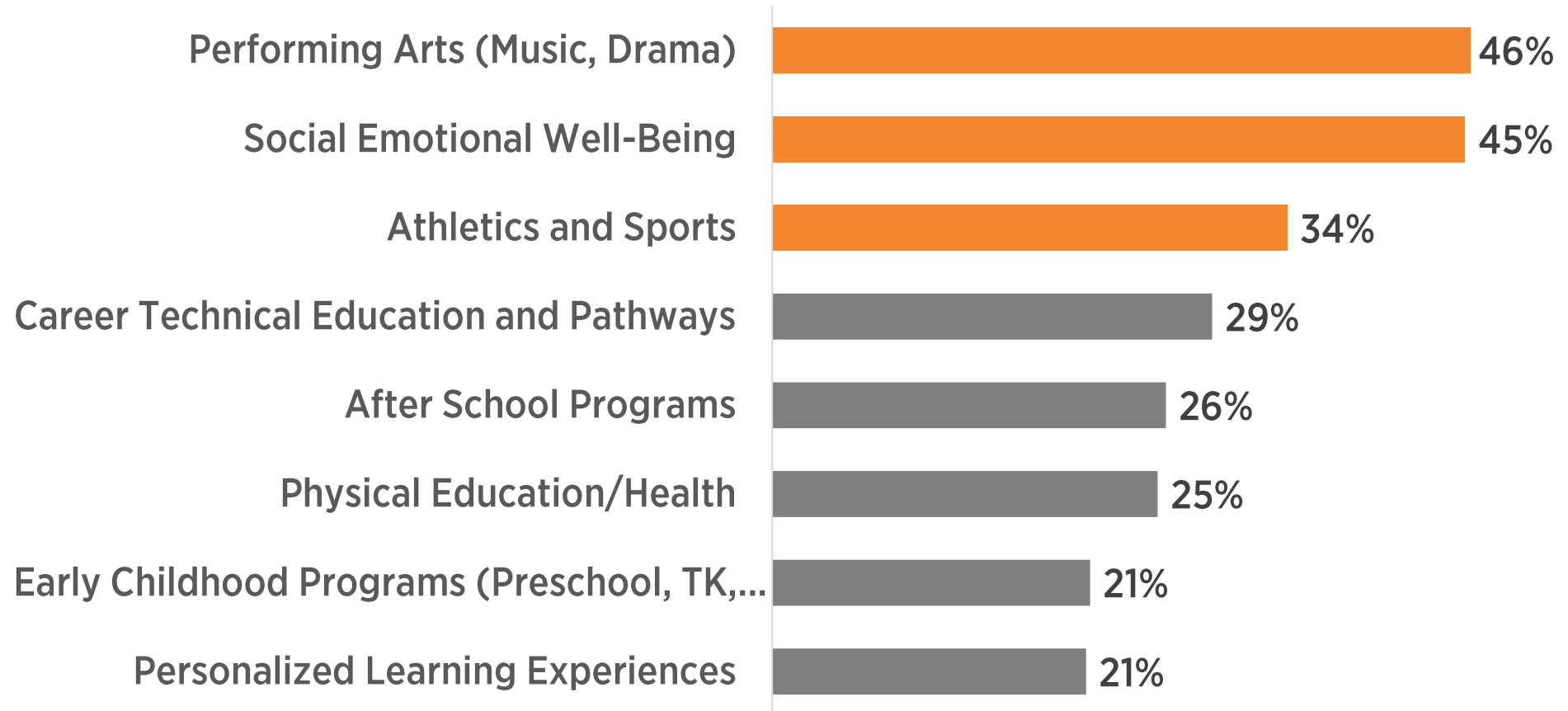

# UNDERSTANDING THE NUMBERS: COMMUNITY SURVEY

updated: 9.5.23



The following **design elements** are most important:

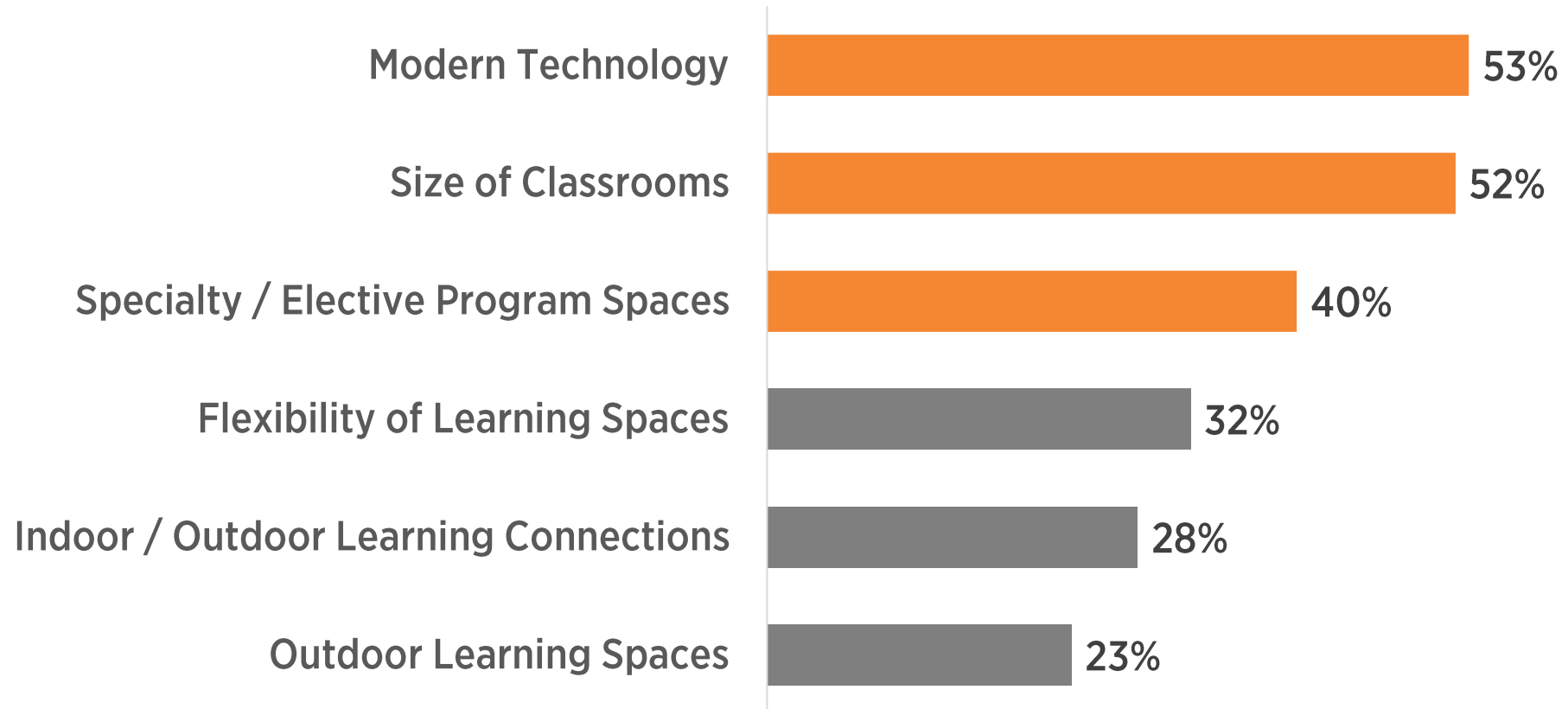

# UNDERSTANDING THE NUMBERS: COMMUNITY SURVEY

updated: 10.5.23



## SRVUSD should consider additional Industry Sectors for Career Technical Education...

- 1 Energy, Environment, & Utilities (72%)
- 5 Manufacturing & Project Development (52%)
- 6 Building & Construction Trades (50%)
- 4 Agriculture & Natural Resources (45%)
- 3 Public Services (43%)
- 2 Marketing, Sales, & Services (38%)

### INSIGHT:

*Energy, Environment & Utilities*  
were the top choice of  
Students *and* Community  
voices...

*but* Students ranked the  
rest in an inverse of the  
Community voice

# TAKE THE COMMUNITY SURVEY



Needs from Campus Visioning Workshops

# **Districtwide Patterns Observed**





# DISTRICT-WIDE PATTERNS OF NEEDS

## CAMPUS VISIONING WORKSHOPS

### NEEDS - - - - - → STRATEGIES

- |   |   |  |
|---|---|--|
| Poor flow of traffic at older sites         | → | Re-design parking lots, lanes, re-think operations         |
| Consistency in security measures            | → | Perimeter fencing if feasible (and non-institutional)      |
| Consistency in security measures            | → | Key cards, videophone buzz-in at Admin, access zoning      |
| Thermally comfortable space for lunch & SEL | → | Modernize MPR's + shaded waterproof outdoor areas          |
| Consistency in outdoor learning opps.       | → | Learning Courts to protect from the elements; nature-based |
| Better Indoor/outdoor connections           | → | Transparency and landscape to extend learning outdoors     |
| Improve the student dining experience       | → | HS Student Union and outdoor dining at all levels          |
| Multi-use spaces for specialized programs   | → | Flexible Labs for Arts, Science, Music and Maker Programs  |



# DISTRICT-WIDE PATTERNS OF NEEDS

## CAMPUS VISIONING WORKSHOPS

### NEEDS - - - - - → STRATEGIES

- Admin too small, especially on older sites → Align **Admin** with ideal sizing
- Intentional space for student support services → **Wellness Centers** for all school types, ES/MS/HS
- Inclusive space for pull out & academic support → **Learning Centers** as a suite of service providers
- Playgrounds need to be more inclusive → Enlarging playgrounds, loose parts, inclusive apparatus
- Libraries for multi-media & collaboration → Including an adjacent **Flex Lab** for makerspace activities
- Shared workspace for teachers → **Satellite Faculty Workrooms** on all campuses
- Space for Professional Development → Dual, adjoining **Annex** classroom for flexible multi-use
- More Staff restrooms → Distribute more Staff restrooms



# DISTRICT-WIDE PATTERNS OF NEEDS

## CAMPUS VISIONING WORKSHOPS, AT HIGH SCHOOLS

### NEEDS - - - - - → STRATEGIES

- Quads feel undefined and stark → Landscape design for space definition of zones w/ shade
- Lack of indoor space for dining → Transform HS Commons into **Student Unions**
- Space for Clubs at lunch → **Student Unions** for flexible multi-use
- Better Athletic facilities on some campuses → Varies by campus (Field House, Gym upgrades, etc)
- Libraries get overcrowded → High School **Study Hall** (20-50 capacity near the Library)
- Libraries get too noisy for students → **Small Group Rooms** as part of the Library



Input

# Common Questions

**Q: Why so many  
Transitional Kindergarten  
and Kindergarten  
classrooms on my  
campus?**

**A: TK is planned as a new full  
grade level, with the overarching  
goal of TK and K as a full-day  
program. When we apply the  
District's loading factor and round  
up to the nearest whole number, we  
get a classroom count much higher  
than what you currently have.**

**Q: Can we add new construction for after school programs? We have long wait lists.**

**A: Campuses can share spaces such as Music, Maker, Science, or other Electives Labs and the Annex for after school programs.**

**Expansion of a non-District-run program is not within this scope.**

**Q: When will this work happen?**

**A:** This is part of our next steps as we move through prioritization activities with this group (FDC) and the SRVUSD Board of Education. Timing is also dependent on funding and a site's modernization eligibility. We will have a clearer picture of timing when the Board adopts this plan in February.



Input from Town Halls and Follow-Ups

# **Districtwide Patterns Observed**



# UNIQUE CONSTRAINTS

## GROUP A: CALIFORNIA HIGH SCHOOL TOWN HALL GROUPING

SITE	UNIQUE CONSTRAINT
Bollinger Canyon ES	Shared-use agreement
Country Club ES	Antiquated original design
Montevideo ES	Shared-use agreement, Recently modernized
Neil Armstrong ES	Recently modernized
Twin Creeks ES	Shared-use agreement, Antiquated original design
Walt Disney ES	Shared-use agreement, Recently modernized
Iron Horse MS	Enrollment concerns
Pine Valley MS	Enrollment concerns
California HS	Enrollment concerns

# UNIQUE CONSTRAINTS

## GROUP B: DOUGHERTY VALLEY HIGH SCHOOL TOWN HALL GROUPING

### SITE

### UNIQUE CONSTRAINT

Bella Vista ES

Shared-use agreement

Coyote Creek ES

Hidden Hills ES

Live Oak ES

Quail Run ES

Shared-use agreement

Gale Ranch MS

Shared-use agreement

Windemere Ranch MS

Shared-use agreement, Enrollment concerns

Dougherty Valley HS

Del Amigo Continuation HS  
Venture Independent Study

# UNIQUE CONSTRAINTS

## GROUP C: MONTE VISTA HIGH SCHOOL TOWN HALL GROUPING

SITE	UNIQUE CONSTRAINT
Creekside ES	Shared-use agreement
Golden View ES	Shared-use agreement, Recently modernized
Green Valley ES	Shared-use agreement, Antiquated original design
Sycamore Valley ES	Recently modernized
Tassajara Hills ES	Shared-use agreement
Vista Grande ES	Shared-use agreement
Diablo Vista MS	Enrollment concerns
Los Cerros MS	Antiquated original design
Monte Vista HS	

# UNIQUE CONSTRAINTS

## GROUP D: SAN RAMON VALLEY HIGH SCHOOL TOWN HALL GROUPING

### SITE

### UNIQUE CONSTRAINT

Alamo ES

Shared-use agreement

Greenbrook ES

John Baldwin ES

Shared-use agreement

Montair ES

Shared-use agreement, Antiquated original design

Rancho Romero ES

Shared-use agreement, Antiquated original design, Recently modernized

Charlotte Wood MS

Shared-use agreement, Recently modernized

Stone Valley MS

Recently modernized

San Ramon Valley HS

Enrollment concerns

Adult Transition and REACH  
Programs (Del Campus)

Revisions made from Town Halls

# **Design Guideline Input**

# LEARNING CENTER & WELLNESS CENTER

## Revised

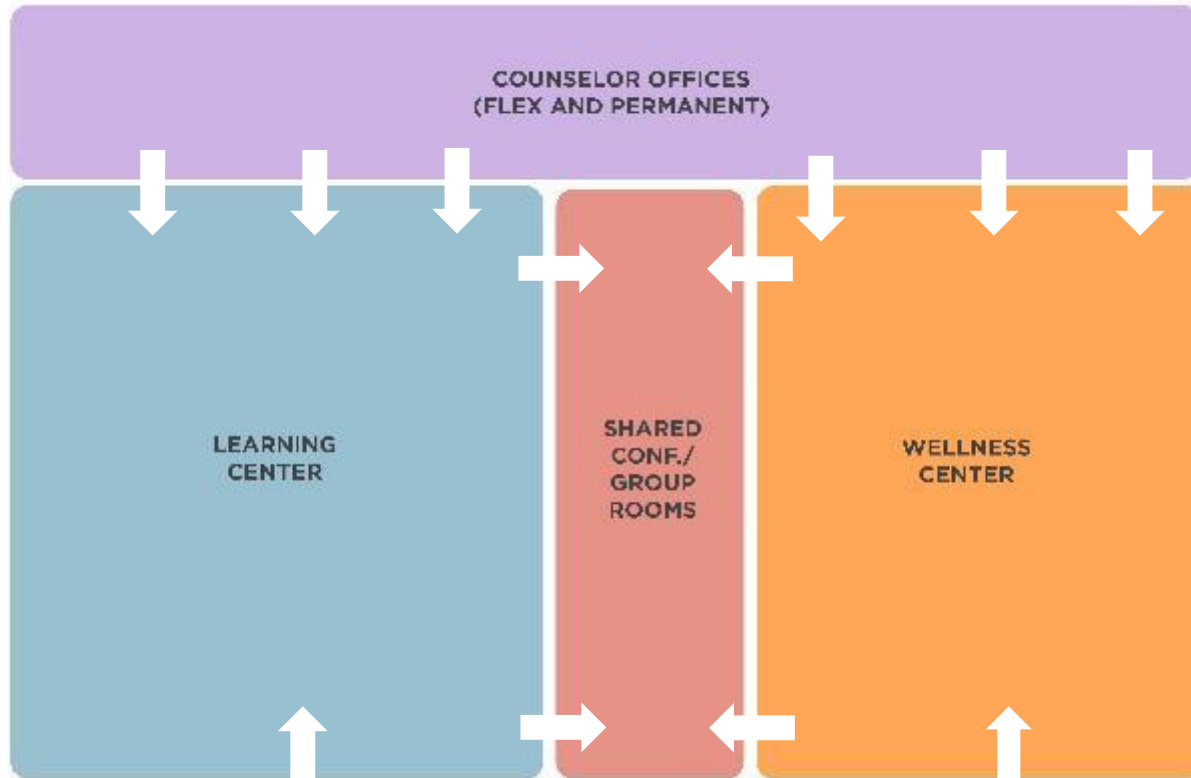

- Shared conference and group rooms
- Offices across both rooms for supervision
- Co-locates counselors for both academic and social





# LEARNING CENTER

## Revised

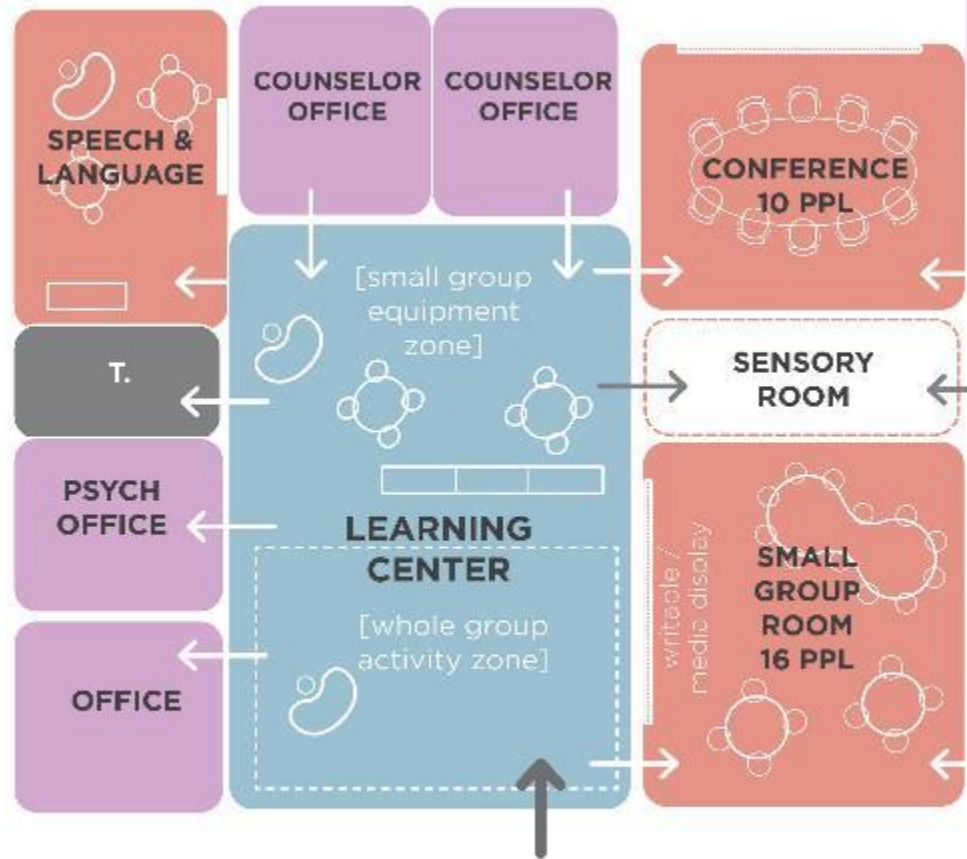

WELLNESS CENTER



# WELLNESS CENTER

## Revised

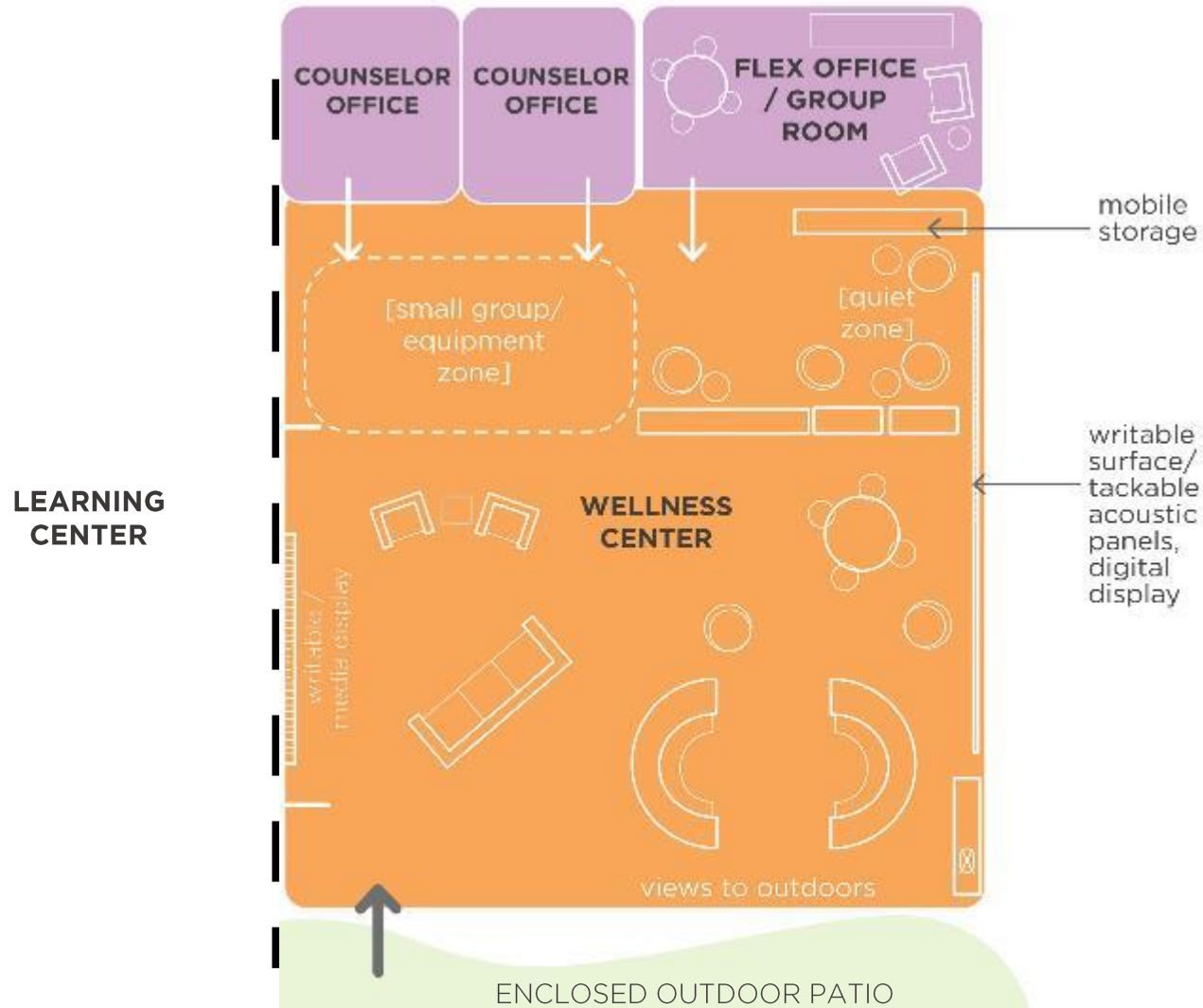

# LIBRARIES FOR GRADES TK THROUGH 8

## Revised

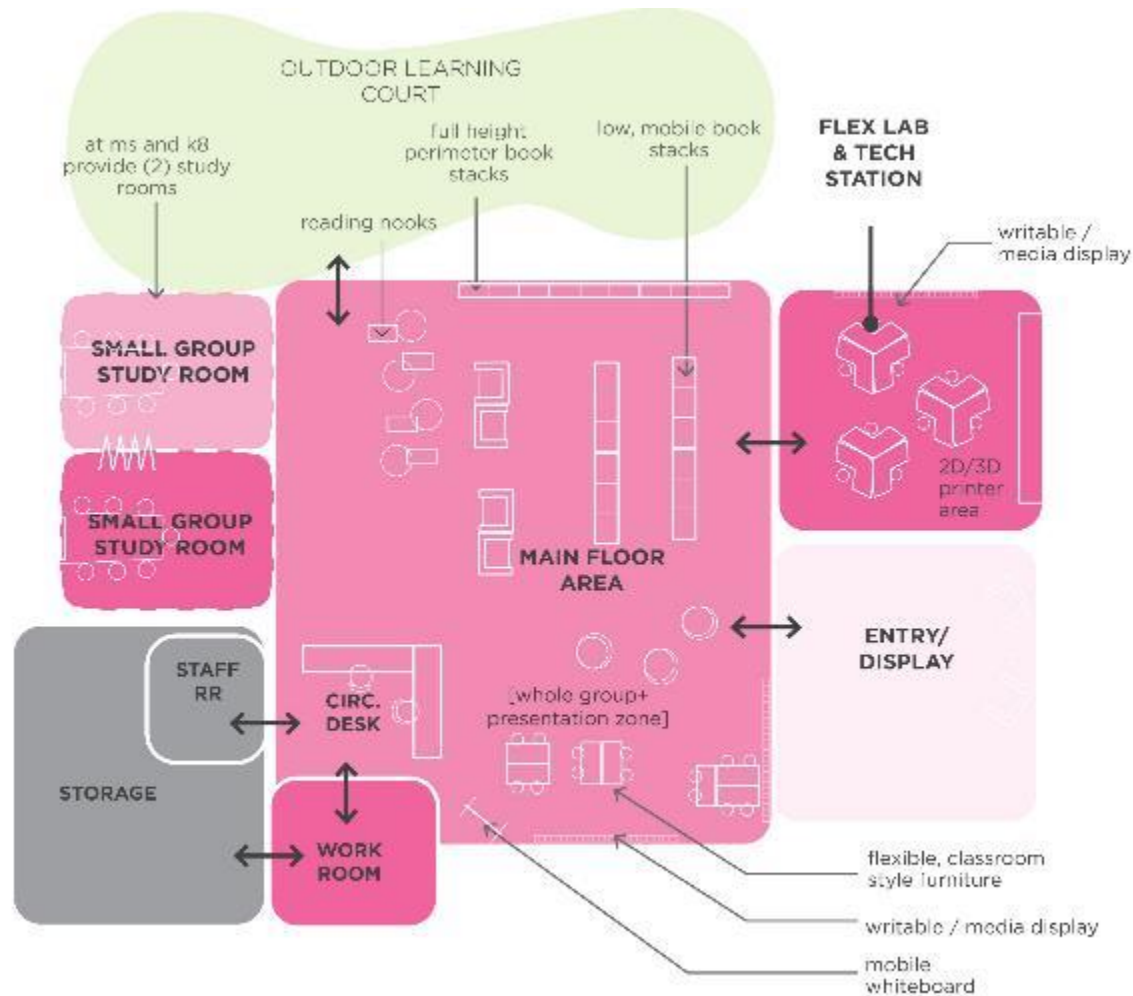

# HIGH SCHOOL LIBRARIES

## Revised

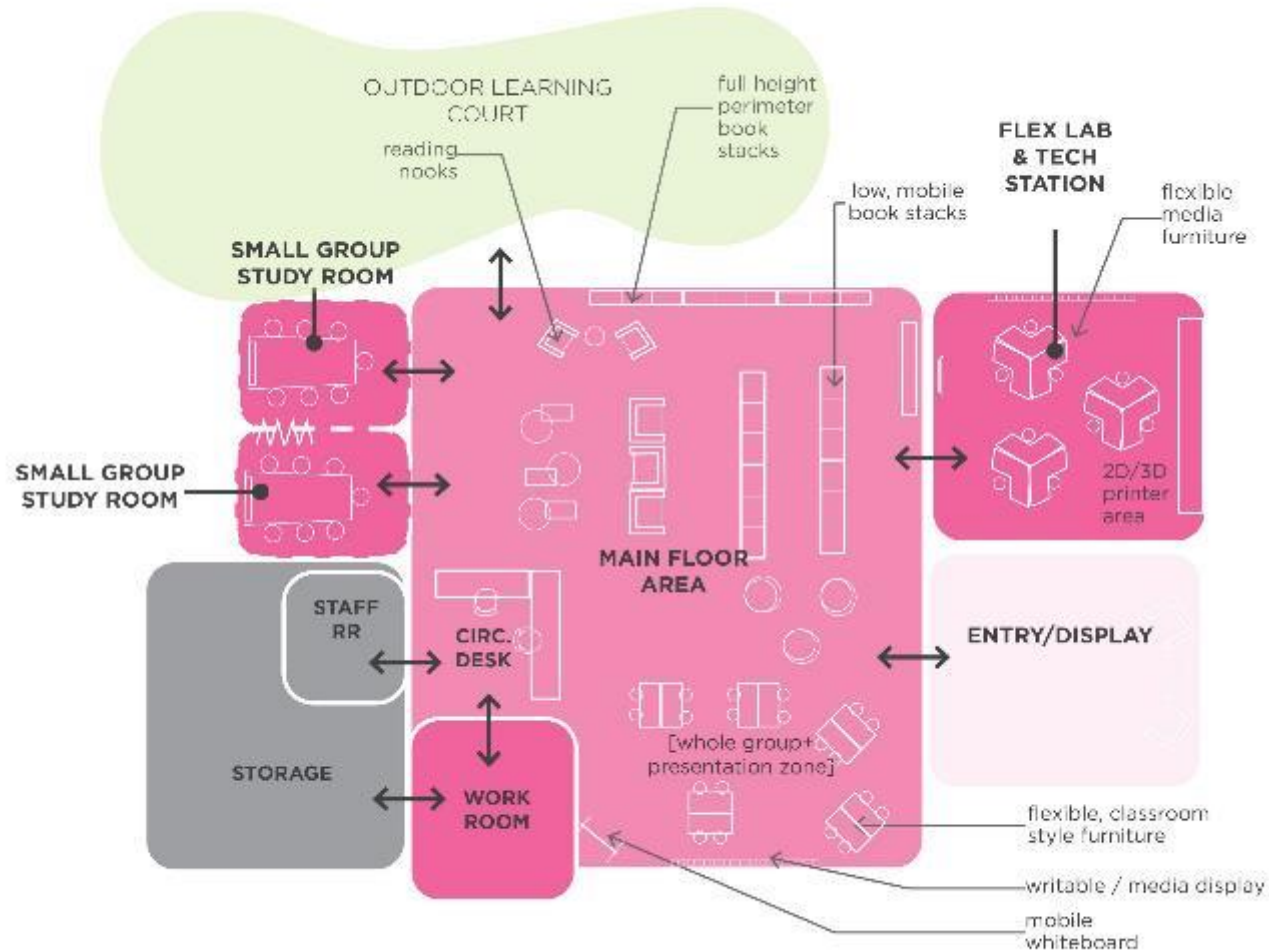

Highly Desired at Town Halls

# **Design Guideline Input**

# ALL ACCESS RESTROOMS CDE Guidelines

<https://www.cde.ca.gov/ls/fa/sf/allaccessrestroom.asp>

Background Planning Design Modernization Cost Laws References

## Background

### What are all-access restrooms?

Traditional school restrooms are gendered—designated separately for boys and girls. Generally, a school restroom is a room that contains multiple stalls for private water closets (toilets), with lavatories (sinks) outside of the stalls. Standard school restrooms also have gendered features, such as urinals and menstrual product dispensers and receptacles.

An all-access restroom is not gendered—all students may access and use the facility. Best practices in design are detailed in these resources, including privacy and supervision features that benefit all students. This guidance uses the term “all-access restroom” to refer to a gender-inclusive facility that contains multiple private water closet compartments or rooms, and self-contained or shared lavatories.

### Rationale for all-access restroom facilities planning and design guidance

Being able to access restrooms safely and without fear of shame or stigma affects student health, learning, attendance, and school climate for all students. Some school districts are responding to student needs by creating all-access restroom facilities that are designed to be inclusive of all genders. Providing guidance on this timely topic supports the CDE’s goals to provide safe, inclusive, and comfortable learning environments that positively affect student achievement and wellbeing.

"Consistent access to safe bathrooms at school is an education equity/education justice issue. I spent years making myself sick—either from anxiety about having to choose which bathroom to use, or from refusing to use the bathroom at all and suffering from chronic infections—because there was nowhere at school where I could safely go for fear of bullying or harassment. This work is life saving for students who have been suffering in traditionally gendered systems for so long." - Benjamin K., Trans Educator



A Comprehensive Analysis of Inclusive & Gender Specific Restrooms in K-12 Schools

INCLUSIVE RESTROOM DESIGN

Cunningham

# ALL ACCESS RESTROOMS

## Added

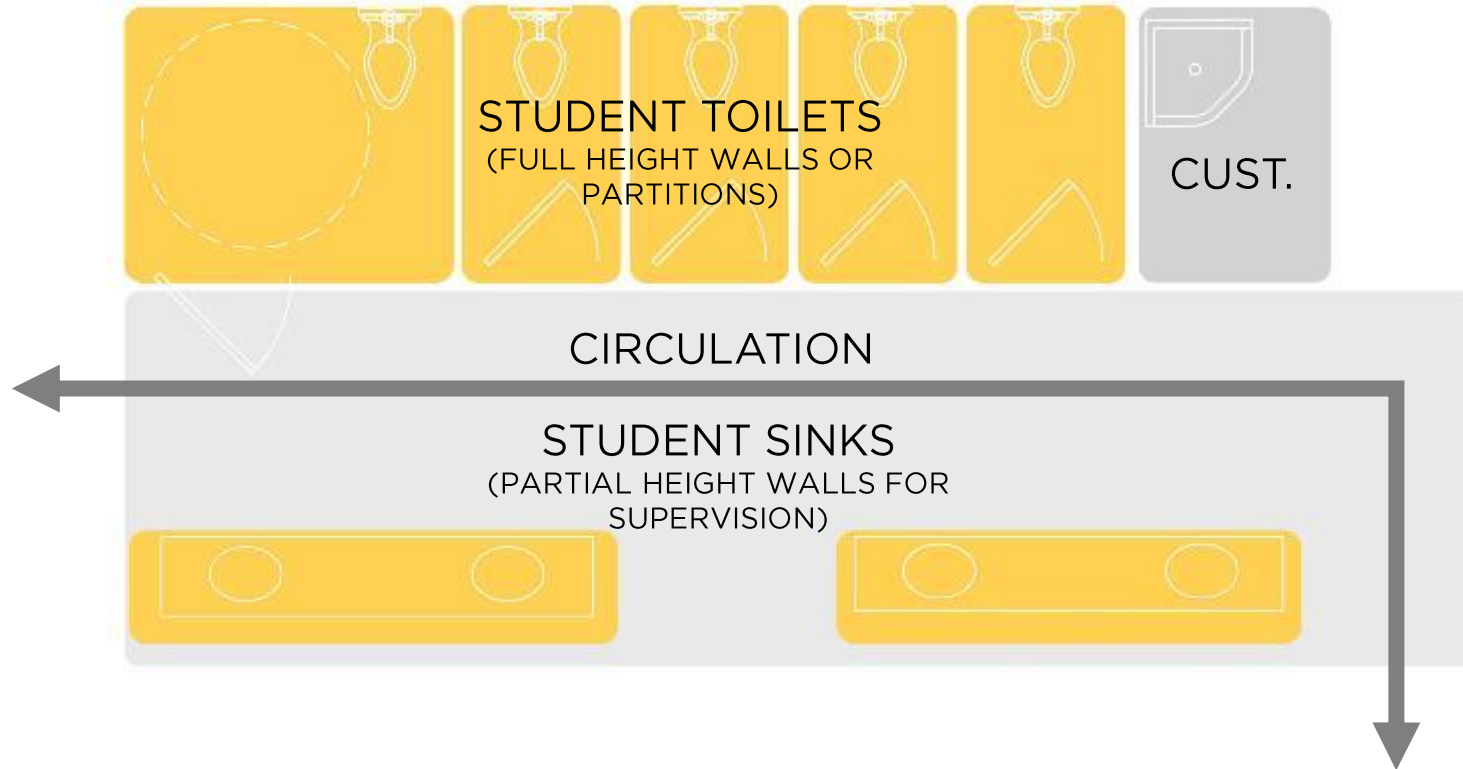

# INDOOR COMMONS

## For all levels

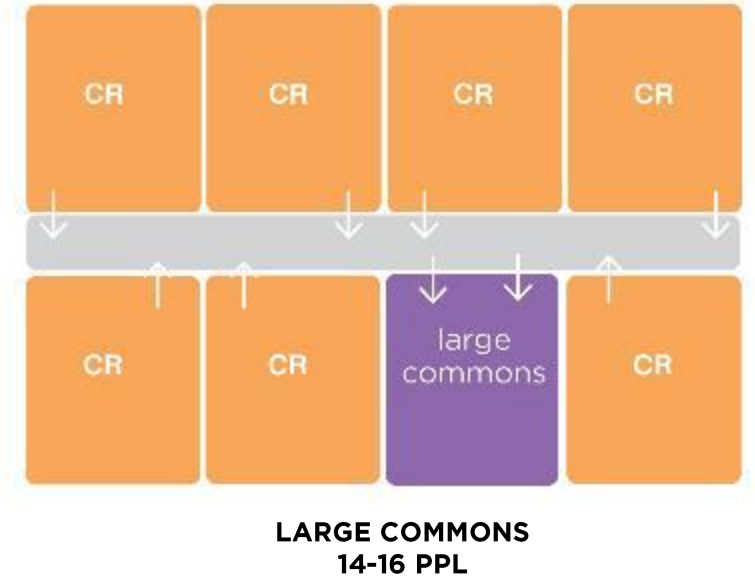
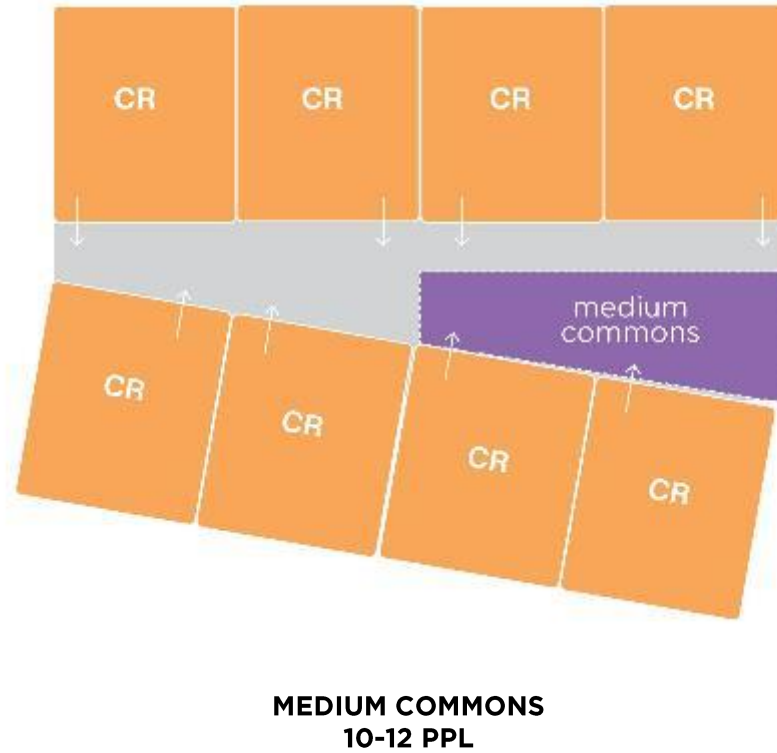

For small group work and collaboration for students.



# INDOOR COMMONS



For small group work and collaboration for students.

# FLEX LABS FOR TK THROUGH GRADE 8

Multi-use for specialized programs & after school

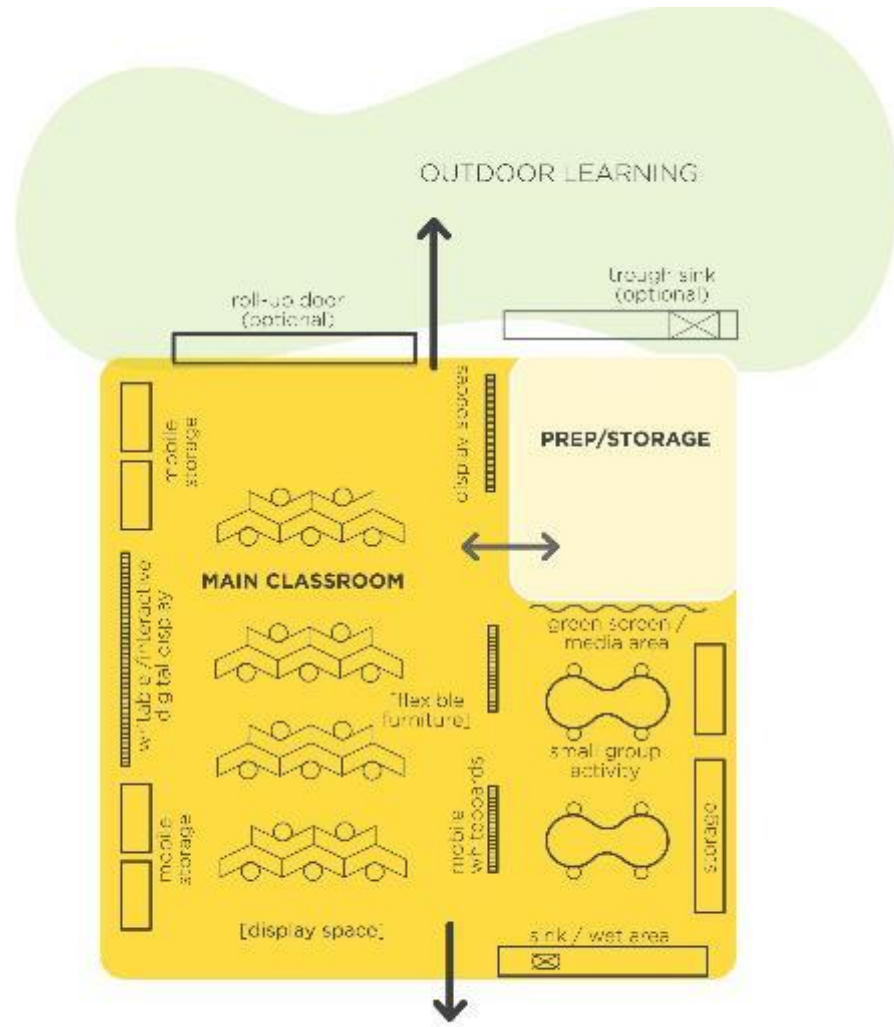

# ANNEX

## Multi-use: indoor PE, small events & after school

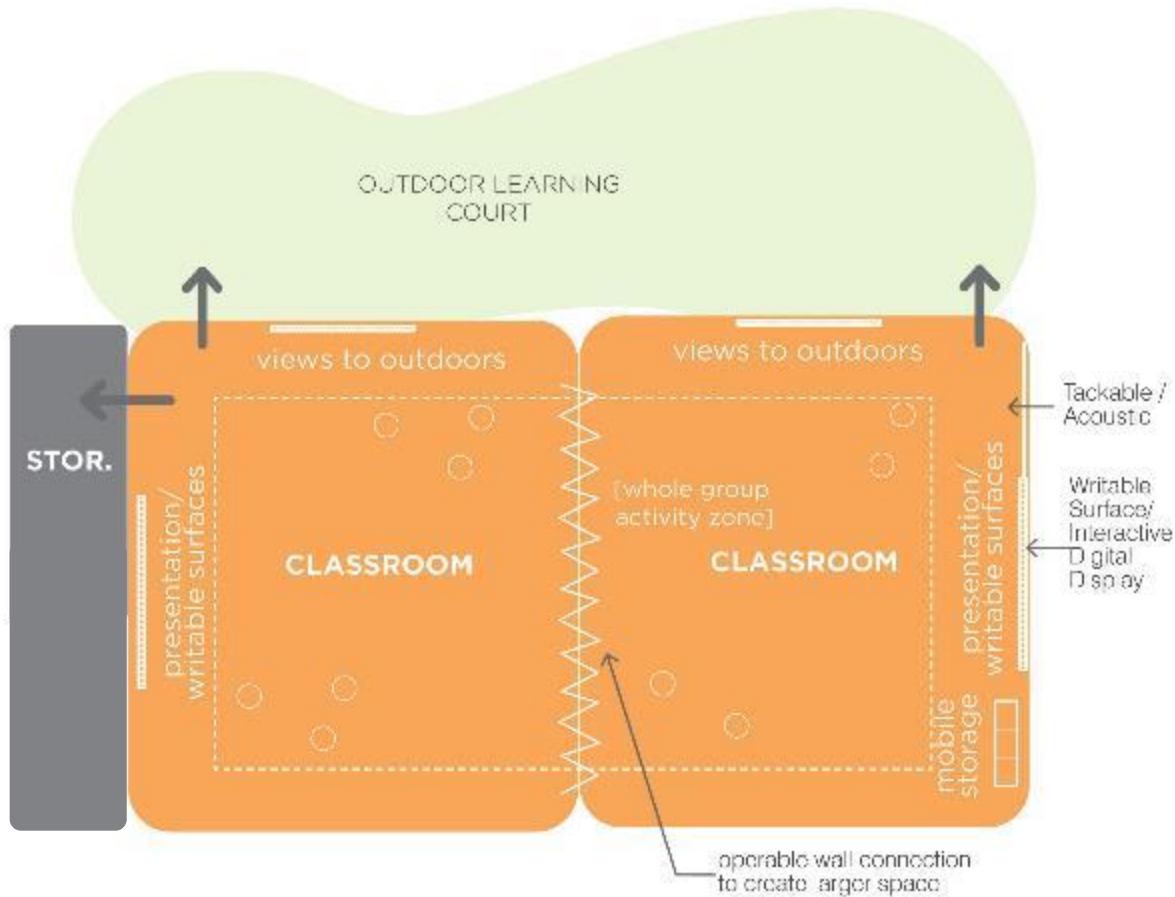

# OUTDOOR COMMONS

## Extending learning outdoors

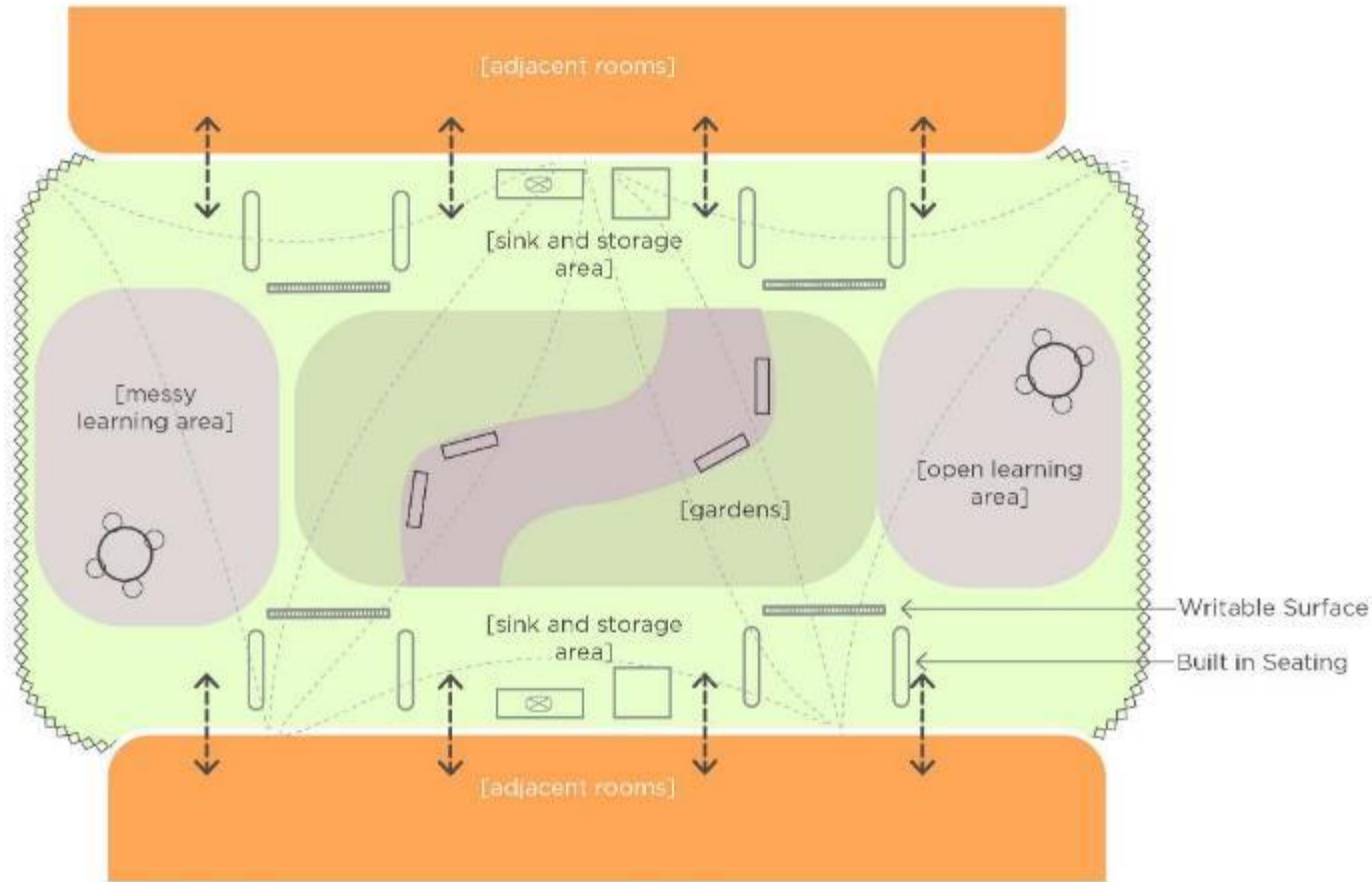

Combines hardscape and landscape to make it low maintenance, not an extra burden to M&O.

# LEARNING COURTS

## Optimizing space between finger buildings

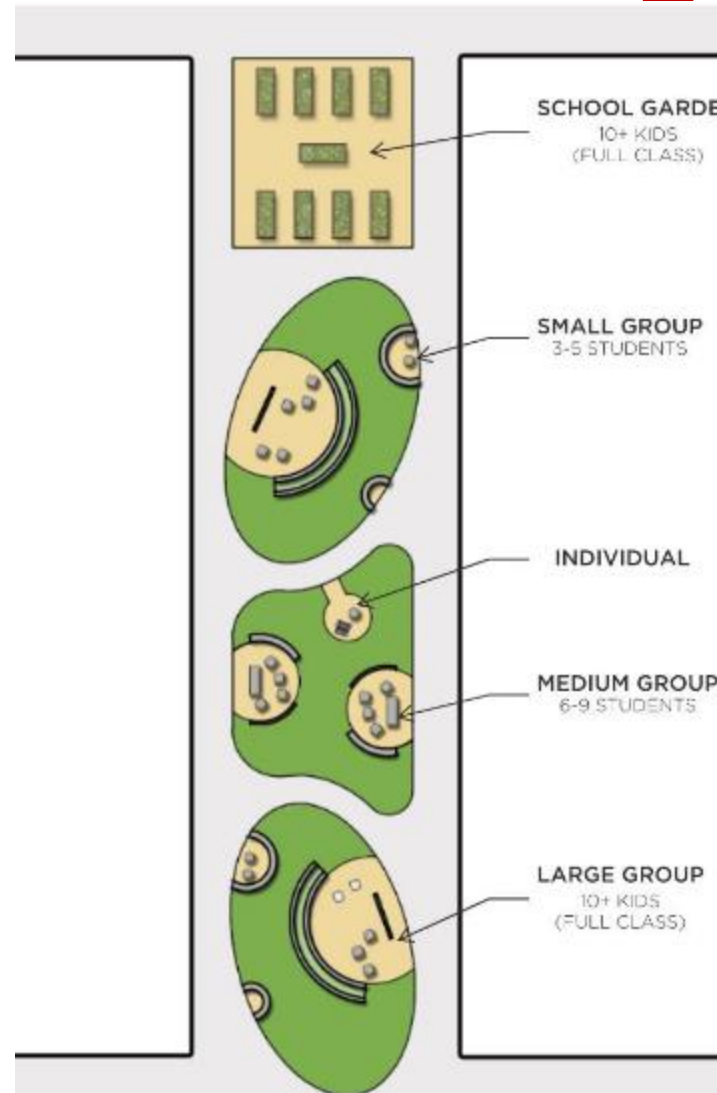
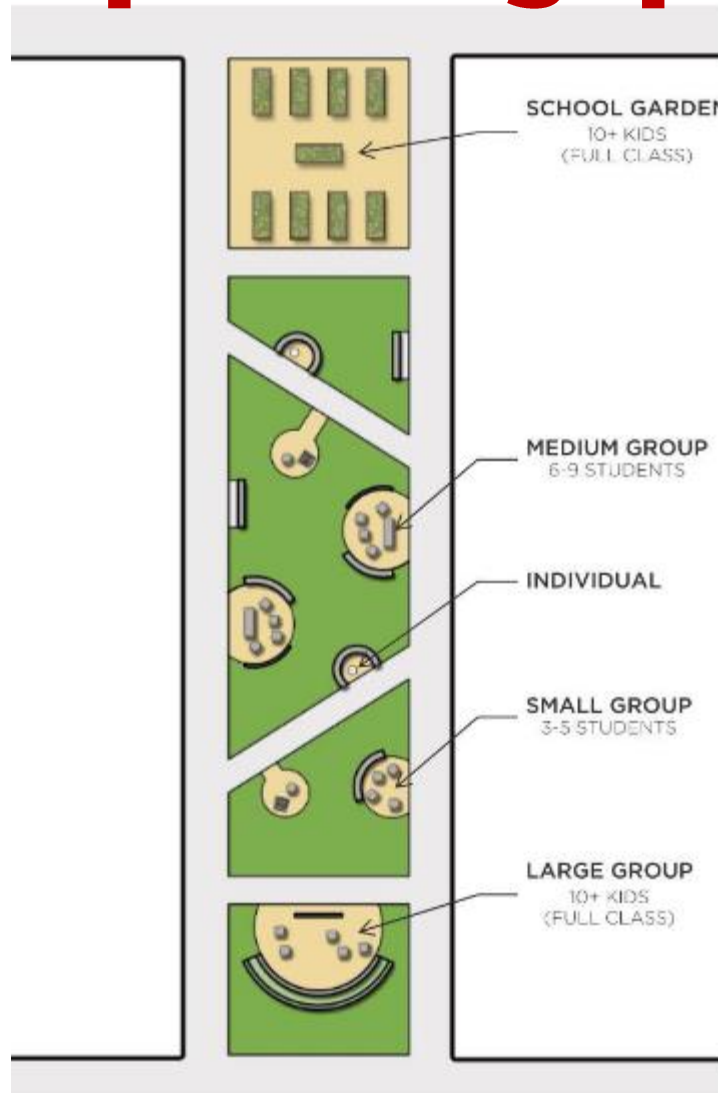

Town Halls & School Site Committee Follow Ups

**Review Site Diagrams Input**

# TOWN HALL SERIES

PART OF THE DISTRICTWIDE LONG-RANGE FACILITIES DEVELOPMENT PLAN



LPA

**September 7<sup>th</sup>**

**5:30 – 7:30pm**

**The Commons at  
California HS**

Bollinger Canyon ES  
Country Club ES  
Montevideo ES  
Neil Armstrong ES  
Twin Creeks ES  
Walt Disney ES  
Iron Horse MS  
Pine Valley MS  
California HS

**September 13<sup>th</sup>**

**5:30 – 7:30pm**

**The Commons at  
Dougherty Valley HS**

Bella Vista ES  
Coyote Creek ES  
Hidden Hills ES  
Live Oak ES  
Quail Run ES  
Gale Ranch MS  
Windemere Ranch MS  
Dougherty Valley HS  
Del Amigo Continuation HS  
Venture Independent Study

**September 14<sup>th</sup>**

**5:30 – 7:30pm**

**The Commons at  
Monte Vista HS**

Creekside ES  
Golden View ES  
Green Valley ES  
Sycamore Valley ES  
Tassajara Hills ES  
Vista Grande ES  
Diablo Vista MS  
Los Cerros MS  
Monte Vista HS

**September 20<sup>th</sup>**

**5:30 – 7:30pm**

**The Library at  
San Ramon Valley HS**

Alamo ES  
Greenbrook ES  
John Baldwin ES  
Montair ES  
Rancho Romero ES  
Charlotte Wood MS  
Stone Valley MS  
San Ramon Valley HS  
Adult Transition and REACH  
Programs (Del Campus)

Group A  
Sept 7  
@ California High School

- Bollinger Canyon ES
- Country Club ES
- Montevideo ES
- Neil Armstrong ES
- Twin Creeks ES
- Walt Disney ES
- Iron Horse MS
- Pine Valley MS
- California HS



# SHIFT TO THE MURAL LINK

Group C  
Sept 14  
@ Monte Vista High School

- Creekside ES
- Golden View ES
- Green Valley ES
- Sycamore Valley ES
- Tassajara Hills ES
- Vista Grande ES
- Diablo Vista MS
- Los Cerros MS
- Monte Vista HS







Changing Lives by Design™